

SPECIFICATIONS	Model	LH875	LH-series						
			75kW, 3-phase						
<p><b>Type of Pump</b> Submersible high head drainage pump for construction and foundation works, floodwater drainage, etc.</p> <p><b>Type of Fluid</b> Stormwater, groundwater, wash water, and sand-carrying water</p> <p>Temperature: 0 to 40°C</p> <p><b>Discharge Bore &amp; Connection</b> 200mm, JIS 10kg/cm<sup>2</sup> Screwed Flange</p> <p><b>Motor Output</b> 75kW</p> <p><b>Power Supply</b> Three-phase</p> <p><b>Starting Method</b> Star-Delta</p> <p><b>Motor</b> Continuous-duty rated, dry-type induction motor</p> <p>Insulation Class: F Degree of Protection: IP68</p> <p>No. of Poles &amp; Speed (Synchronous Speed) 2-pole, 3000/3600min<sup>-1</sup> (50/60Hz)</p> <p>Power Supply Voltages &amp; Rated Currents</p> <table border="0"> <tr> <td>50Hz</td> <td>60Hz</td> </tr> <tr> <td>380V – 140A</td> <td>380V – 137A</td> </tr> <tr> <td>400V – 130A</td> <td>440V – 118A</td> </tr> <tr> <td>415V – 130A</td> <td></td> </tr> </table> <p><b>Power Cable</b> Sheath: Chloroprene rubber Standard Length: 10m 200 to 600V supply: 1 x <math>\begin{pmatrix} 6 \times 30\text{mm}^2 \\ 1 \times 22\text{mm}^2 \\ 3 \times 2\text{mm}^2 \end{pmatrix}</math> O.D. 41.1mm</p> <p><b>Dry Weight (excluding cable)</b> 865kg</p>	50Hz	60Hz	380V – 140A	380V – 137A	400V – 130A	440V – 118A	415V – 130A		<p><b>Impeller</b> Closed Impeller made of high-chromium cast iron</p> <p>Solids Passage 50Hz – <math>\phi</math>20mm 60Hz – <math>\phi</math>20mm</p> <p><b>Mouth Ring</b> Made of high-chromium cast iron, excellent in abrasion-resistance</p> <p><b>Cable Entry with Anti-Wicking Block</b> Watertight cable entry with strain-relief device. The anti-wicking block prevents water incursion due to capillary action should the power cable be damaged or the end submerged.</p> <p><b>Bearing</b> Upper: Cylindrical roller bearing Lower: Duplex angular contact ball bearing mounted back-to-back</p> <p><b>Shaft</b> 420 stainless steel</p> <p><b>Shaft Seal (Mechanical Seal)</b> Furnished with a double-face mechanical seal located in oil chamber. Both upper and lower seal faces always run in a clean environment.</p> <p>Upper Seal Face: SiC + SiC Lower Seal Face: SiC + SiC</p> <p><b>Pressure Relief Port</b> Protects the mechanical seal from over rated limits, and also protects the seal faces from abrasive particles by drawing particles away.</p> <p><b>OIL LIFTER (Patented)</b> Equipped in oil chamber. It forcibly supplies lubricating oil to the mechanical seal and continues to supply the oil to the upper seal faces even if lubricant falls below the rated volume.</p> <p>Type of Lubricating Oil &amp; Volume Turbine Oil (ISO VG32), 6100ml</p> <p><b>Motor Protection Device</b> A miniature thermal protector is embedded in each winding of the motor. Should excessive heat builds up, the bimetal strip opens to cause the control panel to shut the power supply.</p> <p><b>Leakage Sensor</b> Made of 304 stainless steel. It can be wired to a control panel to alert operators of water incursion into the oil chamber.</p> <p><b>Galvanic Anode</b> Protects the pump from electric corrosion, made of aluminium alloy</p>
50Hz	60Hz								
380V – 140A	380V – 137A								
400V – 130A	440V – 118A								
415V – 130A									

NO. A-17763-1

# PUMP PERFORMANCE CURVES

TYPE SUBMERSIBLE GENERAL DEWATERING PUMP (HIGH HEAD)	MODEL LH875 -51	FREQUENCY 50 Hz
--	--------------------	--------------------

CUSTOMER'S NAME \_\_\_\_\_

EQUIPMENT TITLE \_\_\_\_\_ NO. \_\_\_\_\_

	STANDARD SPECIFICATIONS	REQUIRED SPECIFICATIONS
DISCHARGE BORE	200 mm	mm
TOTAL HEAD	60 m	m
CAPACITY	4.5 m <sup>3</sup> /min	m <sup>3</sup> /min
MOTOR OUTPUT	75 kW	kW
PHASE x VOLTAGE	3 $\phi$ x V	$\phi$ x V
CURRENT	A	A
POLES / REVOLUTION	2 P / s. s. 3000 min <sup>-1</sup>	P / min <sup>-1</sup>
STARTING METHOD	STAR DELTA	
INSULATION CLASS	F	

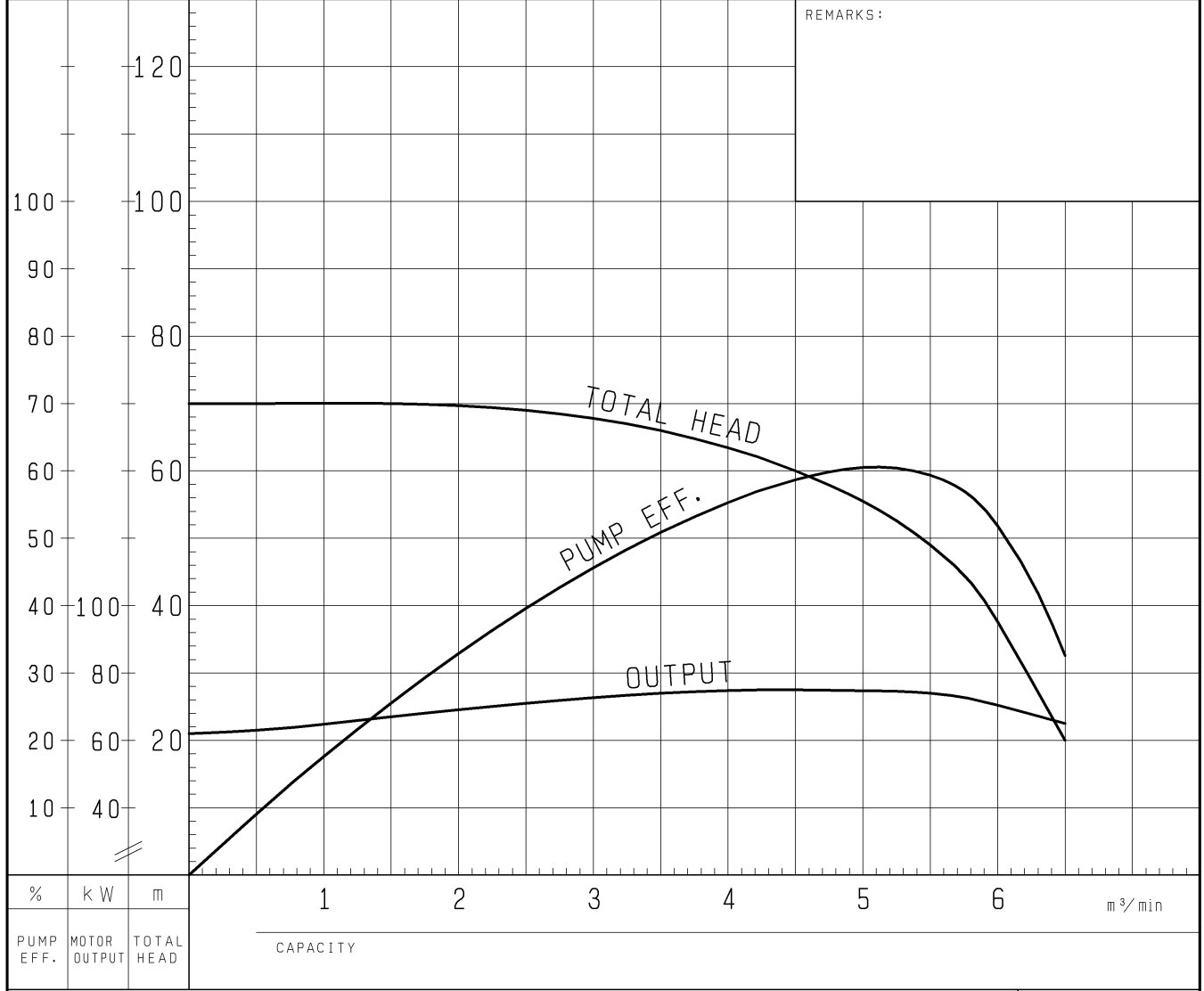

TSURUMI MFG. CO., LTD.

DIMENSION DRAWING		No.	No.	A-17766-2
TYPE	SUBMERSIBLE GENERAL DEWATERING PUMP (HIGH HEAD)	MODEL	LH855 -51/61 LH875 -51/61	

MODEL	Approximate Weight (※)
LH855-51/61	820kg
LH875-51/61	865kg

※excluding cable

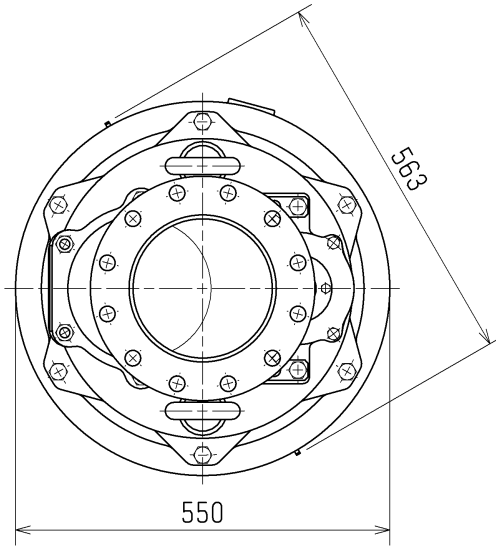

JIS10K Flange  
Nominal Dia.  $\phi$ 200

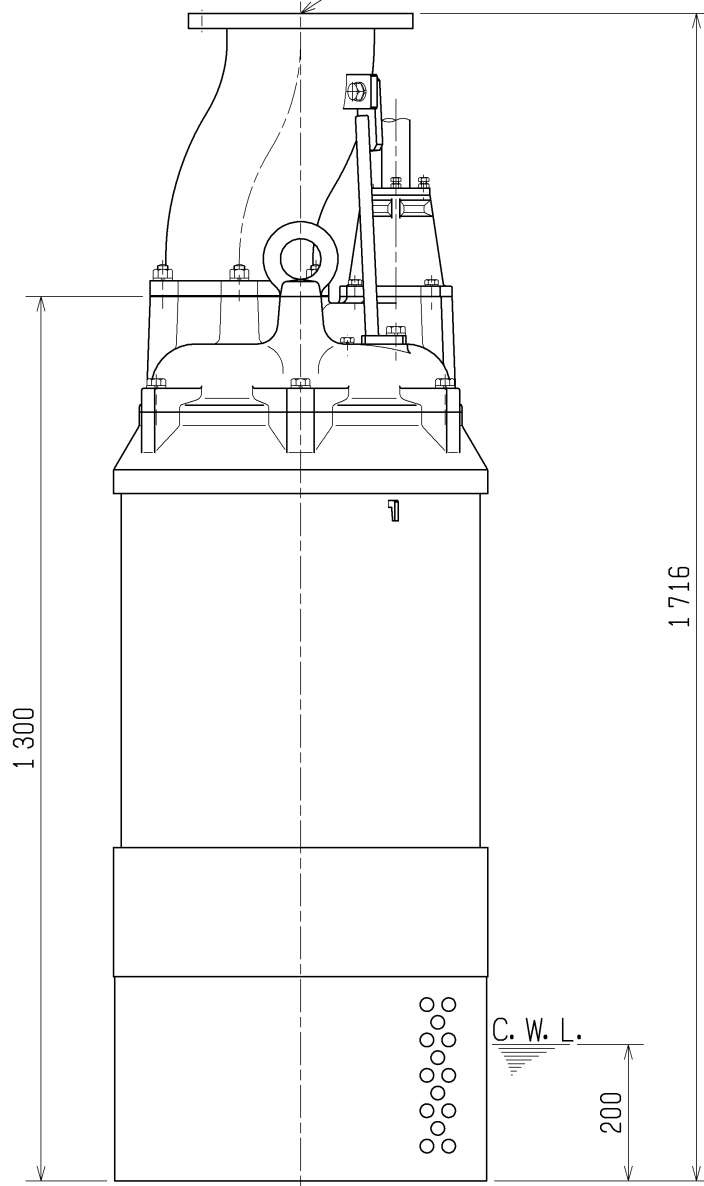

C. W. L. :Continuous Running Water Level

<b>SECTIONAL DRAWING</b>		No.	No. A-17768-2
TYPE	SUBMERSIBLE GENERAL DEWATERING PUMP (HIGH HEAD)	MODEL	LH855 -51/61 LH875 -51/61

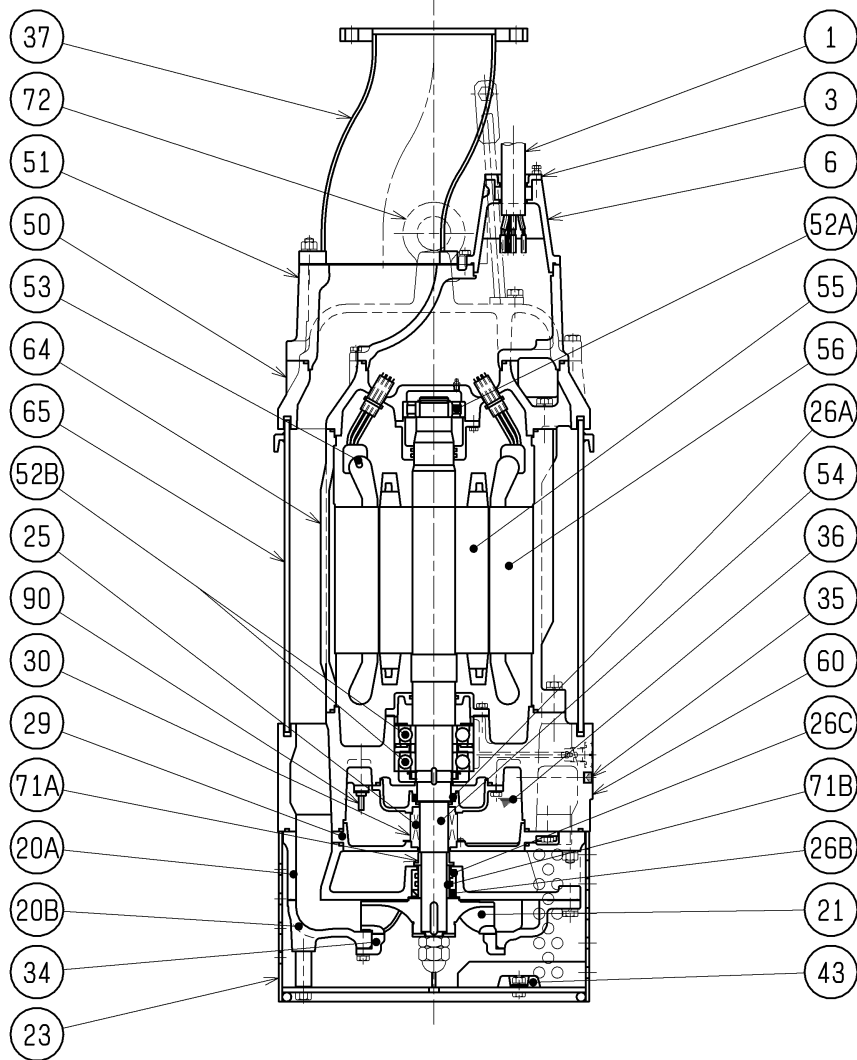

REQ. SPECIFICATION

No.	DESCRIPTION	QTY	MATERIAL / NOTE	No.	DESCRIPTION	QTY	MATERIAL / NOTE
1	Cable	1	Chloroprene Sheath	50	Motor Bracket	1	Gray Iron Casting
3	Gland	1	Gray Iron Casting	51	Head Cover	1	Gray Iron Casting
6	Stuffing Box	1	Gray Iron Casting	52A	Upper Bearing	1	NU310C3
20A	Upper Pump Casing	1	Gray Iron Casting	52B	Lower Bearing	1	7313ATDBC3
20B	Lower Pump Casing	1	Gray Iron Casting	53	Motor Protector	3	
21	Impeller	1	Chromium Iron Casting	54	Shaft	1	Stainless Steel 420J2
23	Strainer Stand	1	Structure Steel	55	Rotor	1	
25	Mechanical Seal	1	H-50TX	56	Stator	1	
26A	Oil Seal	1	TC60759	60	Bearing Housing	1	Gray Iron Casting
26B	Oil Seal	1	TCN557812	64	Motor Frame	1	Gray Iron Casting
26C	Labyrinth Ring	1	Stainless Steel 304	65	Outer Cover	1	Structure Steel
29	Oil Casing	1	Gray Iron Casting	71A	Upper Shaft Sleeve	1	Stainless Steel 403
30	Oil Lifter	1	Steel Sheet	71B	Lower Shaft Sleeve	1	Stainless Steel 403
34	Suction Mouth	1	Chromium Iron Casting	72	Eyebolt	2	Structure Steel
35	Oil Plug	2	Stainless Steel 304	90	Leakage Sensor Electrode	1	Stainless Steel
36	Lubricant		Turbine Oil (ISO VG32)				
37	Discharge Pipe	1	Structure Steel and Carbon Steel Pipe				
43	Cathodic Protection Plate	3	Aluminium Alloy				