

SPECIFICATIONS	Model	HSD2.55S							
		HSD-series 0.55kW, 1-phase							
<p>Type of Pump Submersible slurry pump for construction and foundation works, mining, and quarries, etc.</p> <p>Type of Fluid Water containing sand, mud, and slurry</p> <p>Temperature: 0 to 40°C</p> <p>Discharge Bore & Connection 50mm, Hose Coupling</p> <p>Motor Output 0.55kW</p> <p>Power Supply Single-phase</p> <p>Starting Method Capacitor Run</p> <p>Motor Continuous-duty rated, dry-type induction motor</p> <p>Insulation Class: E Degree of Protection: IP68</p> <p>No. of Poles & Speed (Synchronous Speed) 2-pole, 3000/3600min⁻¹ (50/60Hz)</p> <p>Power Supply Voltages & Rated Currents</p> <table border="0"> <tr> <td>50Hz</td> <td>60Hz</td> </tr> <tr> <td>220V – 3.5A</td> <td>110V – 7.5A</td> </tr> <tr> <td>230V – 3.3A</td> <td>220V – 3.7A</td> </tr> <tr> <td>240V – 3.2A</td> <td></td> </tr> </table> <p>Power Cable Sheath: PVC Standard Length: 5m 100 to 240V supply: 1 x 3 x 1.25mm², O.D. 10.1mm</p> <p>Dry Weight (excluding cable) 14kg</p>	50Hz	60Hz	220V – 3.5A	110V – 7.5A	230V – 3.3A	220V – 3.7A	240V – 3.2A		<p>Impeller Vortex impeller designed for “high-gap structure,” made of high-chromium cast iron</p> <p>Solids Passage 50Hz – ϕ9mm 60Hz – ϕ9mm</p> <p>Agitator High-chromium cast iron</p> <p>Cable Entry with Anti-Wicking Block Watertight cable entry with strain-relief device. The anti-wicking block prevents water incursion due to capillary action should the power cable be damaged or the end submerged.</p> <p>Bearing Permanently lubricated, deep-groove, double-shielded C3 ball bearings</p> <p>Shaft 403 stainless steel</p> <p>Shaft Seal (Mechanical Seal) Furnished with a double-face mechanical seal located in oil chamber. Both upper and lower seal faces always run in a clean environment.</p> <p>Upper Seal Face: Ceramic + Carbon Lower Seal Face: SiC + Ceramic</p> <p>OIL LIFTER (Patented) Equipped in oil chamber. It forcibly supplies lubricating oil to the mechanical seal and continues to supply the oil to the upper seal faces even if lubricant falls below the rated volume.</p> <p>Type of Lubricating Oil & Volume Turbine Oil (ISO VG32), 160ml</p> <p>Motor Protection Device A circle thermal protector built in the motor housing. Directly cuts the motor circuit if excessive heat builds up or an overcurrent condition occurs in the motor.</p>
50Hz	60Hz								
220V – 3.5A	110V – 7.5A								
230V – 3.3A	220V – 3.7A								
240V – 3.2A									

DIMENSION DRAWING		No.	No. A-21021-1
TYPE	Submersible Slurry Pump	MODEL	HSD2.55S -53/63

Approximate Weight (※)
14kg
※excluding cable

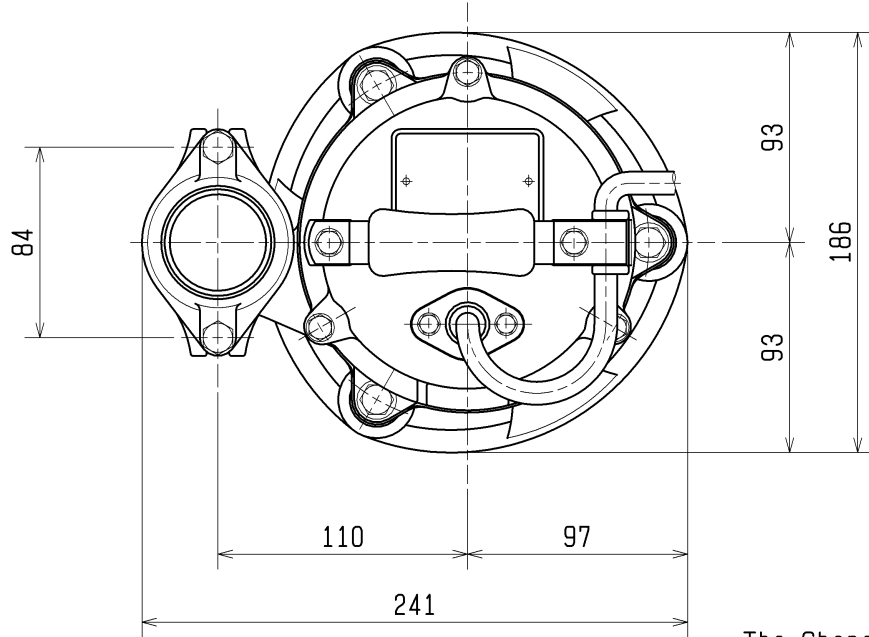

The Shape of the plug

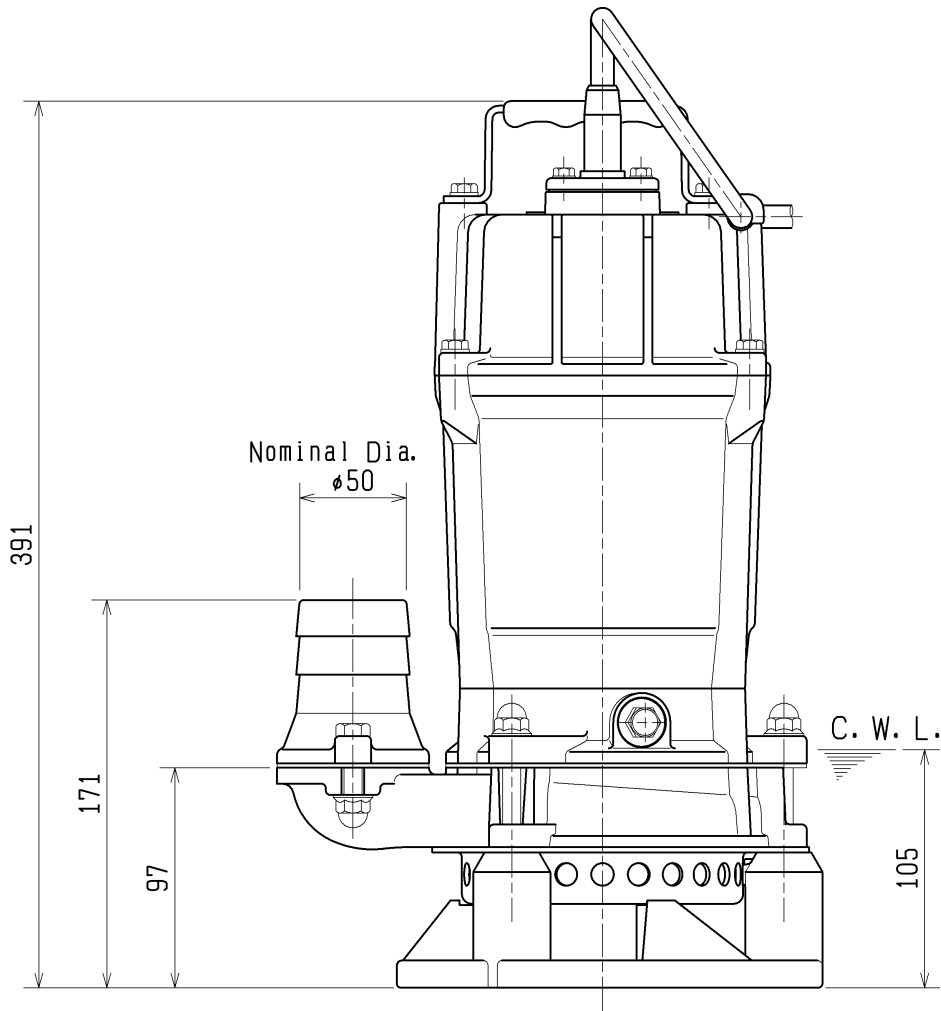
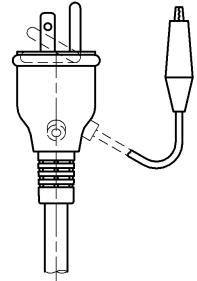

C.W.L. :Continuous running Water Level

SECTIONAL DRAWING		No.	No. A-21022-1
TYPE	Submersible Slurry Pump	MODEL	HSD2.55S -53/63

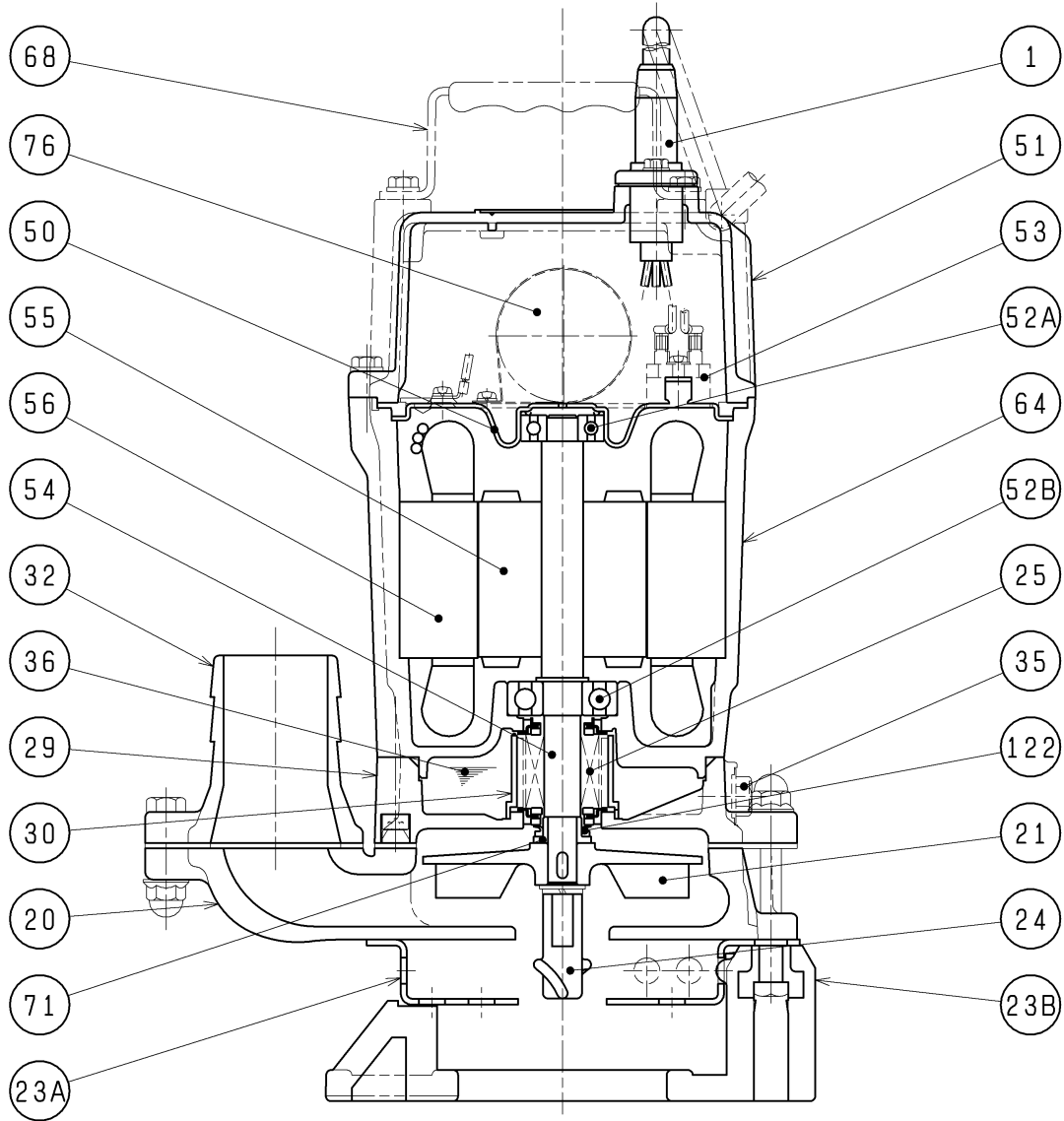

REQ. SPECIFICATION

No.	DESCRIPTION	Q'TY	MATERIAL / NOTE	No.	DESCRIPTION	Q'TY	MATERIAL / NOTE
1	Cabtyre Cable	1	PVC Sheath	52A	Upper Bearing	1	6201ZC3
20	Pump Casing	1	Ductile Iron Casting	52B	Lower Bearing	1	6302ZC3
21	Impeller	1	Chromium Iron Casting	53	Motor Protector	1	
23A	Strainer	1	Steel Sheet	54	Shaft	1	Stainless Steel 403
23B	Stand	1	Vinyl Chloride	55	Rotor	1	
24	Agitator	1	Chromium Iron Casting	56	Stator	1	
25	Mechanical Seal	1	W-14VC	64	Motor Frame	1	Aluminium Die Casting
29	Oil Casing	1	Gray Iron Casting	68	Handle	1	Steel Sheet & Natural Rubber
30	Oil Lifter	1	Plastic	71	Shaft Sleeve	1	Stainless Steel 304
32	Hose Coupling	1	Aluminium Die Casting	76	Capacitor	1	
35	Oil Plug	1	Stainless Steel 304	122	V-ring	1	Nitrile Butadiene Rubber
36	Lubricant		Turbine Oil (ISO VG32)				
50	Motor Bracket	1	Steel Sheet				
51	Motor Head Cover	1	Aluminium Die Casting				